

Parameters

Electrical Parameters:

Power supply	DC12-30V
Communication interface	HDL Buspro

Environmental Conditions:

Working temperature	-5°C~45°C
Working relative humidity	Up to 90%
Storage temperature	-20°C~+60°C
Storage relative humidity	Up to 93%

Approved

CE

RoHS

Product Information:

Dimensions	80×80×28.5 (mm)
Weight	57.9(g)
Housing material	Steel, ABS
Installation	EU wall box
Protection degree	IP20

Installation Steps

- Connect the Buspro cable to the HDL-MPLPI.48-A port and pay particular attention to the wire and port colors.
- Make sure the correct Buspro cable type is used and there are no short circuits.
- Fix the HDL-MPLPI.48-A in the wall box.
- Mount other devices onto the HDL-MPLPI.48-A.

HDL Buspro Cable Guide

CAT5/CAT5E	HDL Buspro	HDLBuspro/KNX
Brown/ Orange	DC24V	Red
Brown white/ Orange white	COM	Black
Blue white/Green white	DATA-	White
Blue/ Green	DATA+	Yellow

Overview

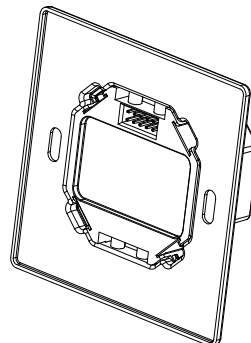

The HDL-MPLPI.48-A Panel Power Interface is a docking base which provides DC power and communication signal for new generation wall-mounted switches and new wall-mounted sensors.

Functions

- The HDL-MPLPI.48-A Panel Power Interface is a universal base for different switches.
- It has an HDL-Bus interface and must work in conjunction with panel or sensor.

Important Notes

- Only use CAT5/CAT5E/HDL Buspro/KNX cable, 0.8mm single-core copper cable.
- Buspro Connection — Series connection (hand-in-hand).
- It must work in conjunction with panel and sensor.

Dimensions (Unit: mm)

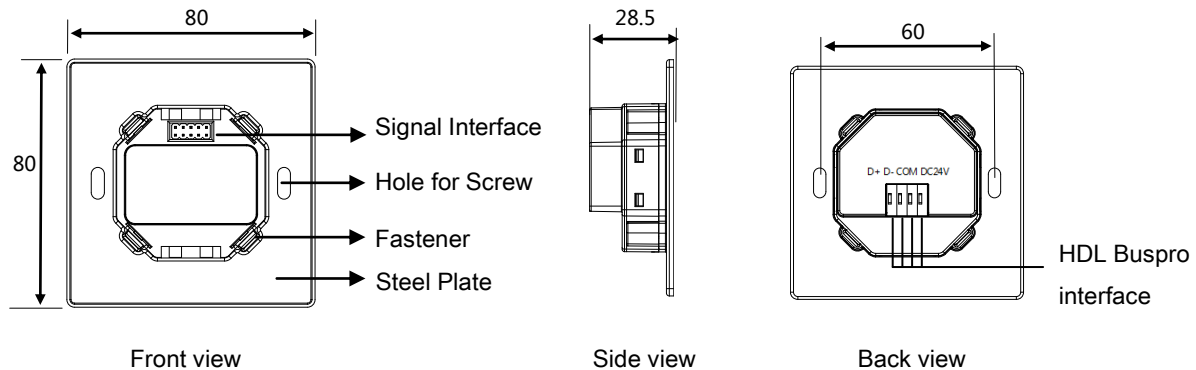

Signal Interface and fastener: They are connected with the panel switch or sensor.

Hole for Screw: It is used for fixing the HDL-MPLPI.48-A into the wall box.

HDL Buspro Interface: The Buspro cable must be connected to the HDL-Buspro Interface of the panel power interface correctly, the sequence from the left to the right: Data+, Data-, COM, DC24V.

Installation

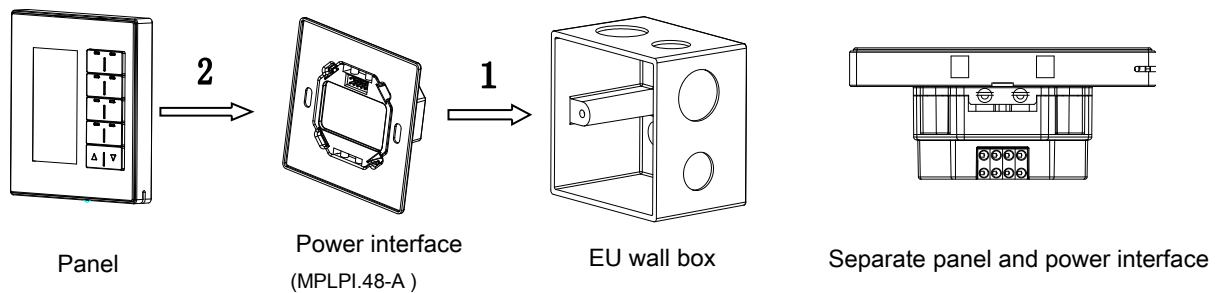

Installation: Hold the edge of panel, insert the power interface module vertically. Do not push the panel too hard.

To disassemble: The panel and panel power interface are in conjunction by magnetic suction, you can split them apart directly.

Safety Precautions

- The panel power interface must work in conjunction with panel or sensor.
- Ensure that the Buspro cable and Buspro interface are making correct connection.
- Never expose the panel power interface to liquids and corrosive gases.
- Must not connect AC power to the Buspro interface of the panel power interface.
- Ensure good ventilation.

Package Contents

- Datasheet*1 / HDL - MPLPI.48-A *1 / Buspro connector*1/screws*2

Contact Us

Need help or advice? Please visit www.hdlautomation.com, or Contact us via: support@hdlchina.com.cn.