

# Instructions for installation of single house outlets typeline HDLA iSocket

## Safety at installation:

The outlet is designed for current up to 16 A and voltage up to 250 V AC. Therefore, the installation must be performed by a person properly qualified in electrical engineering.

### 1. During installation of the outlet, the following conditions must be observed:

- The outlet mounting box must be located flush with the plaster
- The outlet is fastened in the mounting box through a plastic frame by means of two screws of 3 mm diameter (Fig. 1)
- To install multiple sets of fittings, it is necessary to use multiple boxes with the spacing of centres of 71 mm
- It is recommended to place the outlet in the mounting box at the approximate depth of 42 mm

### 2. Outlet connection:

- The outlets are suitable for connection of wires of cross-sections of 1,5 mm<sup>2</sup> to 2,5 mm<sup>2</sup>
- Strip the wires in the maximum length of 10 mm
- Tightening torque of clamping screws max. 1 Nm
- After installation of the outlet in the box, it is necessary to check whether the wires are fixed in the fitting terminals correctly and firmly; loose wires should be retightened

### 3. Finishing the outlet installation:

- Set the frame onto the outlet (Fig. 2)
- Insert the upper cover part and secure it by tightening the screw (Fig. 3)
- Take extra caution when mounting into Glass frames, tighten screws with a torque of 0,05 Nm, full tightening can create material stress and eventually cause breaking of Glass frame, especially when mounting multiple

Installation of single house outlet (with/without a child protection)

Fig. 1

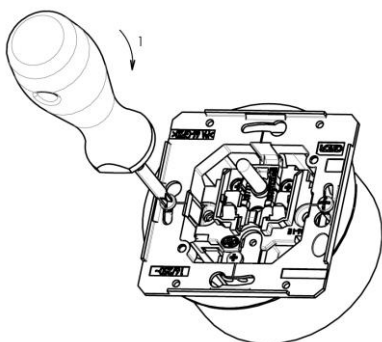

Fig. 2

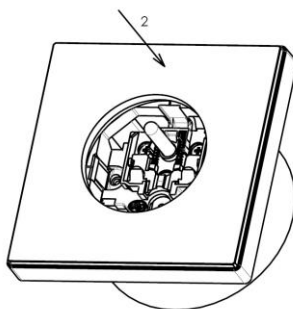
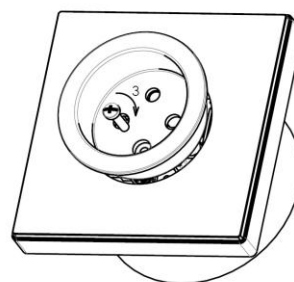
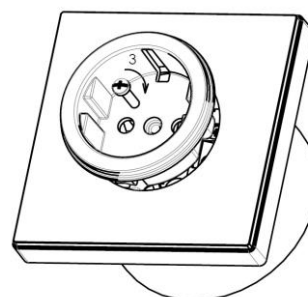
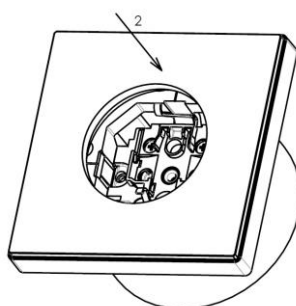
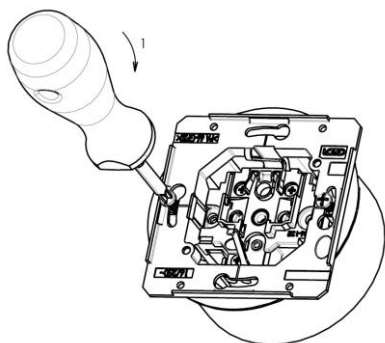

Fig. 3



Installation of outlet DIN (without a child protection)



## Maintenance:

Device covers must never be wiped or washed by abrasive cleaning cloths or aggressive chemicals (petrol, acetone, etc.) may be used on them.

The product contains no hazardous substances; after expiration of its service life, it must be handled in conformity with the waste act in force or pertinent related regulations.

**Warning:** Do not use the malfunctioning or damaged device and prevent it from being used. Disassembly must be entrusted to a person with an appropriate electrotechnical qualification. If the device is not fitted with viewing parts, it must not be placed in a voltage state.