

## Parameters

### Electrical Parameters:

Power input	DC12-30V
Buspro power consumption	200mA/DC24V
Signal type	DMX512 (1990)
HMI	128x64 raster graphic LCD 6 soft-touch buttons
RJ45	RJ45-TCP/IP network interface
Control channel	512
Ethernet network interface	10Mbps/RJ45

### Environmental Conditions:

Working temperature	-5°C~45°C
Working relative humidity	Up to 90%
Storage temperature	-20°C~+60°C
Storage relative humidity	Up to 93%

### Approved:

CE
RoHS

### Product Information:

Dimensions	144×90×66 (mm)
Weight	428.6g
Housing material	Nylon, PC
Installation	35mm DIN rail installation
Protection degree	IP20

## Installation Step

- 35mm DIN rail installation, inside the DB Box
- Mark up each output connection cable
- Connect the load and HDL Buspro cable
- Check if there is any short circuit in output connection cable
- Check the HDL Buspro connection, avoid any mistake
- Isolate the high power and low power
- Tighten the screw again for all terminals

## HDL Buspro Definition for Cable

CAT5/CAT5E	HDL Buspro	HDL Buspro/KNX
Brown/ Orange	DC24V	Red
Brown white/ Orange white	COM	Black
Blue white/ Green white	DATA-	White
Blue/ Green	DATA+	Yellow

## Overview



**SB-DN-512DMX**, DMX show controller. It can input DMX512 signal and control RGB LED light, DMX devices, etc.

## Functions

- It has up to 16 areas. Each area can set 0-1024 scene, and the scene's running time is up to 60 minutes
- Total is 99 sequences, 4 running modes are available for each sequence: forward, backward, forward & backward, random
- DMX512 (1990 version)
- Supports Art net / HDL Net DMX protocol
- Low threshold, high threshold, maximum threshold are all available for each channel for different devices
- Each channel has light protection delay time (0-25 seconds)
- Each channel has protection delay time for power on after power off (0-60 minutes)
- Gateway between HDL-Bus and Ethernet

## Important Notes

- Buspro cable - HDL Buspro/KNX cable, 0.8mm single-core cable.
- Buspro connection - Series connection (hand-in-hand).
- DMX cable - Shielded twisted cable, less than 200 meters
- DMX load - Less than 32 devices.

## Dimensions and Wiring

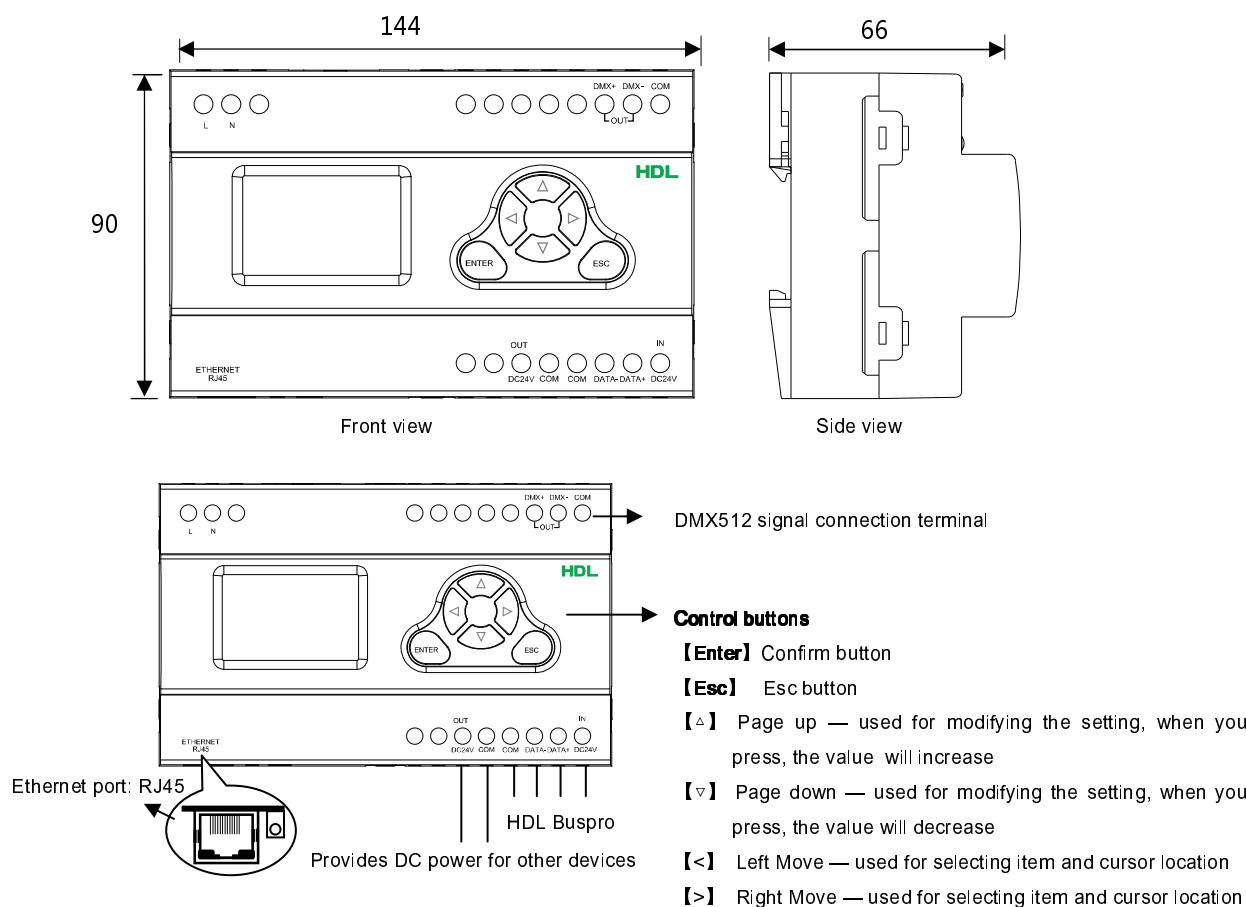

**Note:** When you press all direction keys at the same time, the module will be reset.

## Safety precaution

- The screw down strength should not exceed 0.4Nm.
- Do not make wrong connection on Bus interface, it will damage the Bus interface of this module.
- Do not let the liquids get into the module, it will damage this device.
- Do not get AC220V voltage into Bus wire, it will damage all devices in the system.
- Ensure good ventilation.
- Avoid contact with liquids and corrosive gases.

## Packing list

- SB-DN-512DMX\*1
- Datasheet\*1