

## Parameters

Electrical Parameters:	
Buspro power supply	12-30V DC
Buspro power consumption	25mA/24V DC
Range of temperature sensor	-20°C~+60°C
Range of LUX sensor	0~5000Lux
Range of humidity sensor	20%~95%
Environmental Conditions:	
Working temperature	-5°C~45°C
Working relative humidity	Up to 90%
Storage temperature	-20°C~+60°C
Storage relative humidity	Up to 93%
Approved	
CE	
RoHS	
Product information:	
Dimensions	80(Diameter)×32(mm)
Net weight	92.5(g)
Housing material	ABS
Installation	Ceiling mount
Protection rating	IP20

## Important Notes

- Installation position — Indoor and ceiling-mount, keep it away from AC outlet.
- Ambient temperature - please keep the temperature in the range of 0-36 °C
- Buspro cable — CAT5E or HDL Buspro/KNX cable.
- Buspro connection — Series connection (hand-in-hand).
- Installation-Ceiling mounted.

## HDL Buspro Cable Guide

CAT5/CAT5E	HDL Buspro	HDL Buspro/KNX
Brown/ Orange	24V DC	Red
Brown white/ Orange white	COM	Black
Blue white/Green white	DATA-	White
Blue/ Green	DATA+	Yellow

## Overview



HDL-MASTH.2C is a sensor with built-in temperature sensor, LUX sensor, humidity sensor and dry contact input. The logic in the sensor can manage all different conditions of sensors, to control different targets and achieve different functions. The sensor supports HDL security function and security command.

## Functions

- Built-in LUX sensor, temperature sensor, humidity sensor, 2 channels dry contact inputs, 2 universal switch, Logic
- 2 logical relations: OR, AND
- It has 24 logic blocks, the output is to control the targets
- The range of universal switch number in logic function is 201-248, each logic has 2 universal switch numbers.
- Multiple control targets: Scene switch, Sequence switch, Universal switch, Single channel lighting control, Broadcast scene or channel, Curtain switch, GPRS, Panel control, Security, Music play, etc.
- Supports upgrade from HDL Buspro.

## Dimensions and Wiring

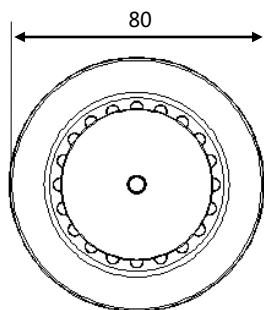

Front view

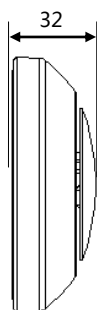

Side view

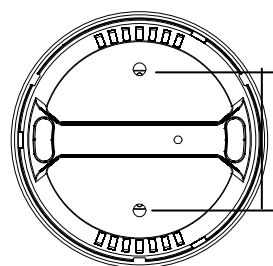

Back view

Screw holes 44.5mm

HDL Buspro, from left to right GND, 485-, 485+, 24V DC

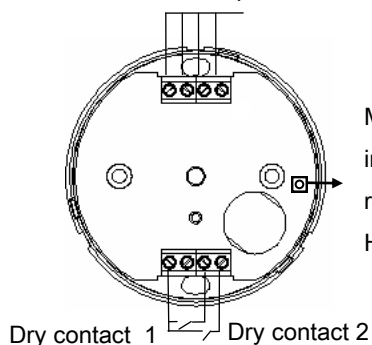

Inside view

Module indicator, flickers when the module is working properly. Keep pressing for 3 seconds, user can read and modify the address of the module in the HDL Buspro software.

Dry contact 1

Dry contact 2

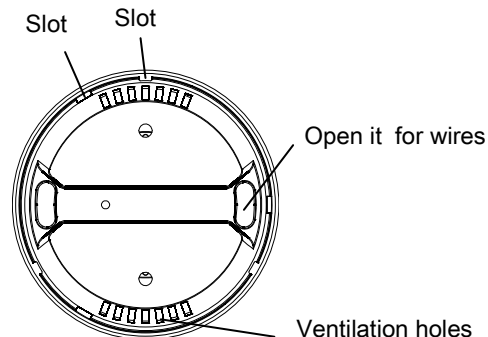

Ventilation holes

## Safety Precautions



- Do not make wrong connection on Buspro interface, it will damage the Buspro interface of this module
- Do not get AC power into Buspro wire, it will damage all devices in the system
- Avoid contact with liquids and corrosive gases.
- Ensure good ventilation.

## Packing list

- HDL-MASTH.2C 1pc
- $\Phi 3 \times 14$  self-drilling screw 2 pcs
- Datasheet 1 pc
- Warranty card 1 pc

