

Parameters

Electrical Parameters:	
Power voltage	DC16~30V
Rated voltage	AC220V 50Hz
Static direct-current power	0.7W
Dynamic direct-current power	1.2W
Working voltage range	AC190~235V
Working current	0.6A
Rated power	140W
Rated torque	10Nm
Rated speed	17r/min
Terminal	HDL Buspro
Db	42dB
Environmental Conditions:	
Working temperature	-5°C~45°C
Working relative humidity	<90%
Storage temperature	-20°C~+60°C
Storage relative humidity	<93%
Approved:	
CE	
RoHS	
Product Information:	
Dimensions	Φ45×75.5(cm)
Tube diameter	55mm
Maximum load	15kg
Weight	2800g
Housing material	Steel
Installation	Wall hanging
Protection	IP44
Insulation	H

Installation Steps

- The drive adapter installs in the tubular motor.
- Tubular motor installs into the tube.
- The idler installs in the tube.
- And then the tube installs in the motor bracket.
- According to the windows, whether or not you can decide to install the wall brackets.
- If you install the wall brackets, use the tubular motor to install in the wall brackets.

Overviews



HDL-MVSM45B.12 is the tubular motor. It can control the roller shutter by HDL Buspro. It has overheat protection.

Functions

- Tubular motor can control to open, close, stop and percentage.
- Communication: HDL Buspro.
- AC motor is power source, provide enough power, it can make the torque of tubular motor big enough.
- Overheat protection.
- Supports online upgrading.

HDL Buspro definition for cable

HDL Buspro	HDL Buspro/KNX
DC24V	Red
COM	Black
DATA-	White
DATA+	Yellow

Important Notes

- Buspro connection - Series connection (Hand-in-hand).
- The maximum load is 15KG.
- When you install the motor, you need to test by HDL-BUS Pro Setup tool.
- It has overheat protection. When the motor is overheat, it will stop until the motor temperature is cooling.
- Maximum running time is 4min.
- The tube length should not more than 4m and less than 0.85m.
- The motor has restore function, if the data is wrong, the indicator will turn red, and flash 2 times/2s. Now, you should test by HDL Buspro Setup Tool again.

Dimensions and Wiring

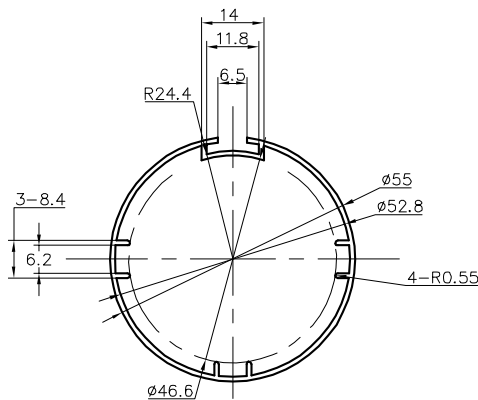
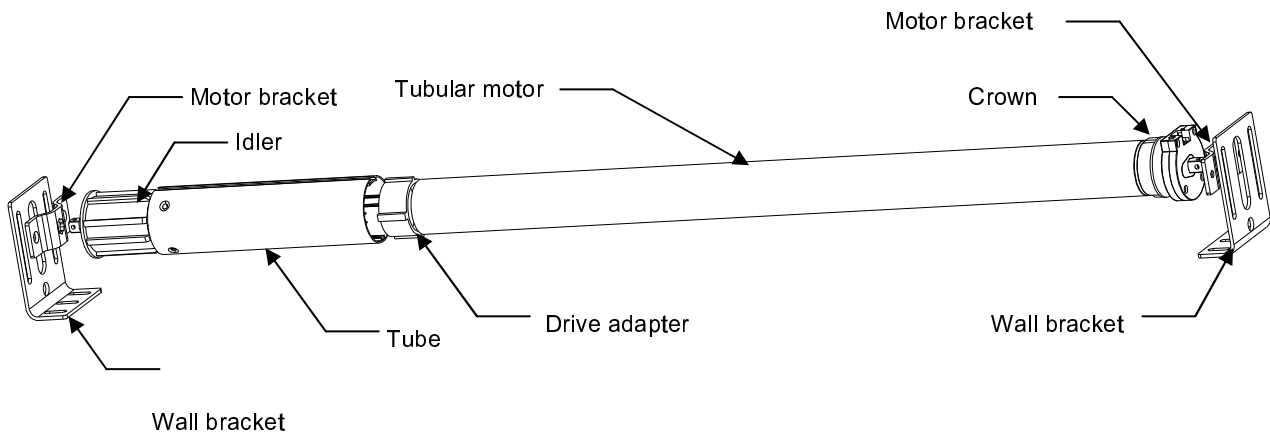

Tube dimension

Note: The roller shutter should be bought by customer, we won't provide it. The tube dimension is shown as left picture.

LED indicator

Function	LED status	Enter into the status	Exit the status
Working properly	LED flashes, 1 time/2s	- -	- -
Modify the address of motor	LED flashes	Long press the button for 3s	Long press the button for 3s / no operation for 2minutes
Testing for installation	LED flashes, 1 time/2s	Long press the button for 5s	Long press the button for 5s / no operation for 20minutes

Notes: The above operations are carried out in normal work.

Safety Attention

- Do not make wrong connection on Buspro interface, it will damage the Buspro interface of this module.
- Never let liquids get into the module, it will damage this device.
- Ensure good ventilation
- Avoid contact with liquids and aggressive gases
- When the motor is installed, please do not pull the curtain with too much force, and do not put any additional weight on the rail, do not climb the curtain and do not hang anything on the roller shutter.

Package contents

- Device *1 / Datasheet *1/ Bus terminal *1