

Parameters

Electrical Parameters (from HDL-MPPI.46):	
Working power	12~30VDC
DC current	45mA/24VDC
Buspro Terminal	0.75-0.85mm Diameter Single Core
Environmental Conditions	
Working Temperature	-5°C~45°C
Working relative Humidity	Up to 90%
Storage Temperature	-20°C~+60°C
Storage relative Humidity	Up to 93%
Approved	
CE	
RoHS	
Product Information:	
LCD Resolution	240x80
Dimensions	86×116.5×10.5 (mm)
Weight	129g
Housing material	Glass , ABS, PC
Installation	GI Wall-Box
Protection rating	IP20

Important Notes

- It must work in conjunction with HDL-MPPI.46 (be installed in wall-box)

Installation Step

- Mount the HDL-MPPI.46 in the wall-box.
- Make sure the Bus cable type is correct and has no short circuit.
- Connect buspro cables. Make sure the color of wire complies with the definition.
- Put this device into HDL-MPPI.46.

HDL Buspro Cable Guide

CAT5/CAT5E	HDL Buspro	HDL Buspro/KNX
Brown/ Orange	DC24V	Red
Brown white/ Orange white	COM	Black
Blue white/ Green white	DATA-	White
Blue/ Green	DATA+	Yellow

Overview



HDL-MPTL14.46 Multifunction LCD panel is the new design and new generation wall mount panel. It has 8 touch buttons, these buttons can be programmed separately. Each control button can be displayed with an Icon in the LCD screen and customization for the end-user. There are 2 buttons to be used for the page shifting. 4 shortcut buttons can reach to the certain page, the page can be defined by user.

Functions

- Adjustable LCD backlight and LED indicator.
- Multipage, Specified page for floor Heating, HVAC, music control function.
- Icon for Key Buttons can be defined by user.
- Button indicator's color is RGB.
- Wake up function.
- Shortcut button function.
- Button combination and Double Button combination function available.
- Button mutual exclusion available.
- Upgrading online from HDL Buspro is available.
- Multi Key Mode: Invalid, Single on-off, single on, single off, Combination on-off, combination on, combination off, double click/single on-off, double click/combination on-off, momentary, clock, short/long press, short press/long momentary press.
- Multi Key control Mode: Scene, Sequence, timer switch, universal switch, single channel on-off, broadcast scene, broadcast channel, curtain, GPRS Control, Panel Control, alarm control, music play, General control.
- Functions including the following: IR Receiver is optional, lock, AC control, heating control, music control, lighting control, curtain control, security control, multimedia control.

Dimensions and Wiring

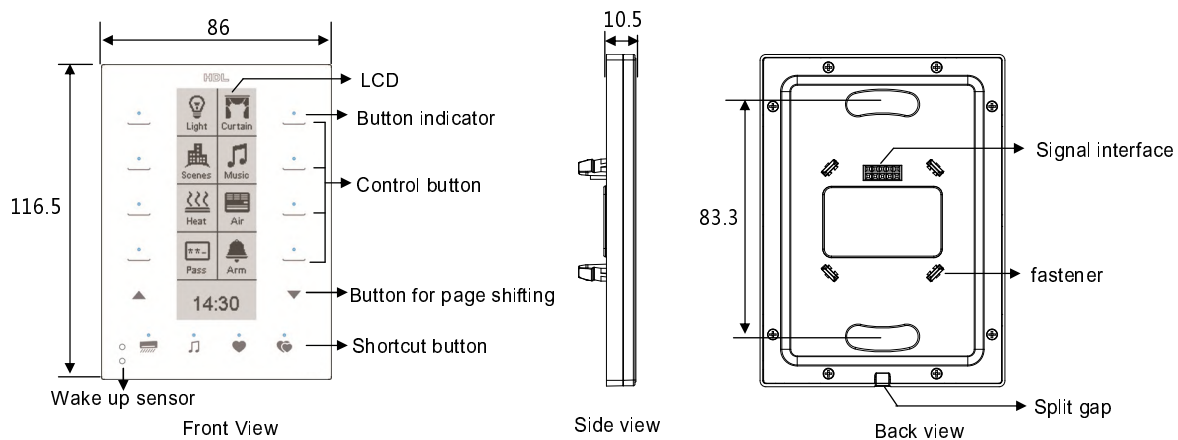

LCD: Display icons, user can design icons from manage software.

Control Button: To control targets.

Button Indicator: Indicates the status of the controlled target. On- Status on; Off- Status off. User can define the color of status.

Dimming: When control types are scene and single-channel lighting on-off, keep pressing the button for dimming.

Button for page shifting: For user to select different pages.

Shortcut button: Directly reaches to a certain page.

Wake up function: The LCD will light up if a hand approaches the panel.

Signal interface and fastener: Connect to panel power interface (MPPI.46).

Split gap: Insert a slotted screwdriver to the split gap, separate the panel and power module (MPPI.46).

Installation

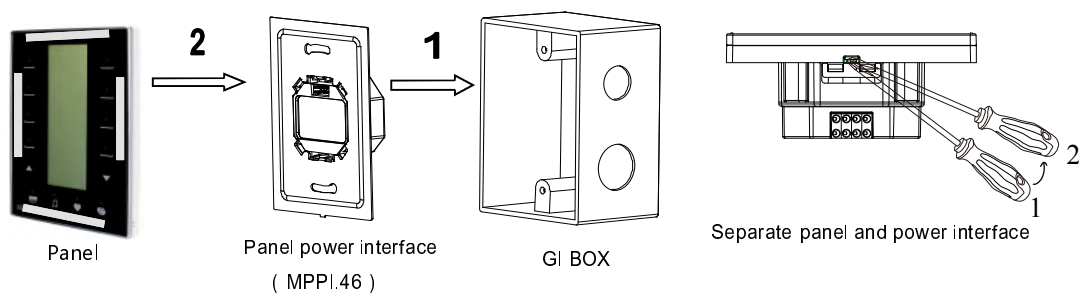

Installation: Held the edge of panel (shown as above grey area), insert the power interface module vertically. Do not push the panel too hard.

Split: Insert a 2.5mm-screwdriver to the split gap. Pry up from position 1 to 2, wiring hole will open. Then separate the panel and MPPI.48.

Safety precaution

- Mounting position: indoor
- Do not make wrong connection on Buspro interface, it will damage the Buspro interface of this module
- Never let liquids get into the module, it will damage this device
- Do not get AC power into Bus wire, it will damage all devices in the system

Packing List

- Datasheet*1 / panel *1